

INSTRUCTION MANUAL

HGC-1T Girder Clamp 1 Tonne 75-230mm

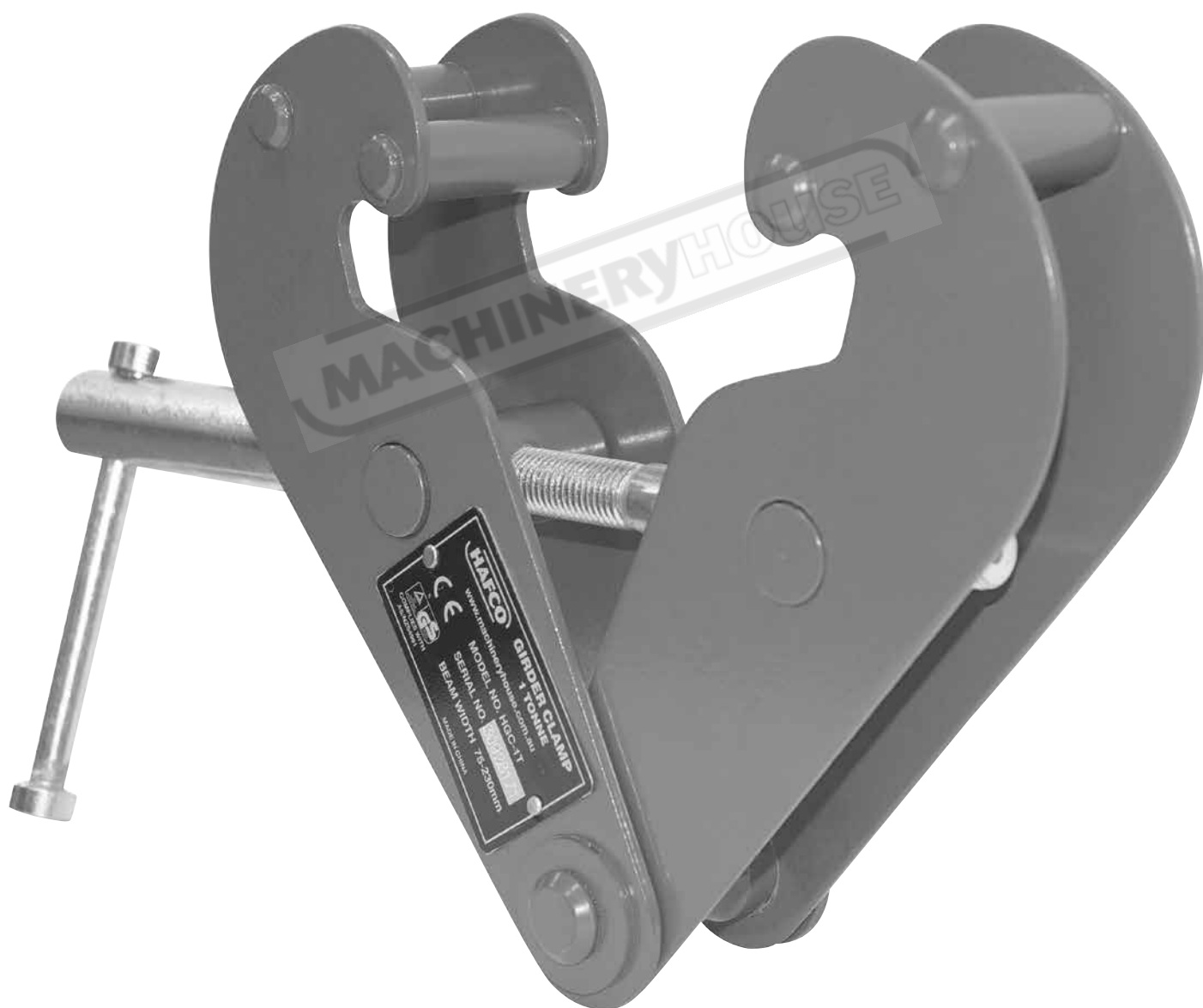

C146

Beam Clamp



AS/NZS4991

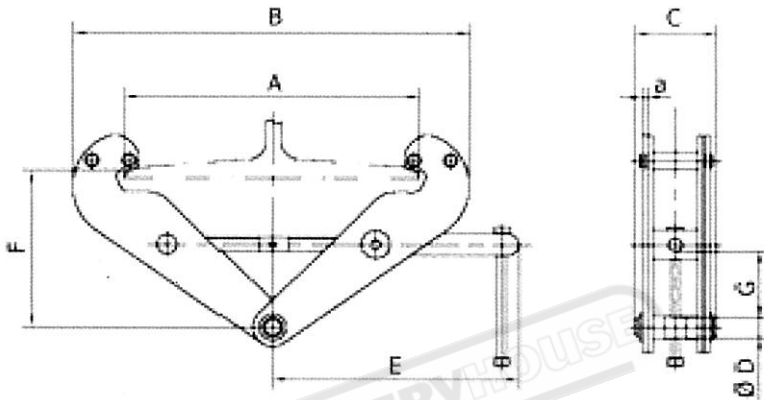

HGC-1T A Type Beam Clamp Specification

Model		HGC-1T	
Rated Capacity kg		1000	
Beam Width		75-230mm	
Dimensions mm	Amax		284
	B	Min	180
		Max	375
	C		80
	a		4
	E		220
	F	Min	102
		Max	160
	G min		29
ØD		20	
Net weight	kg	4	

Beam Clamp



INSTRUCTIONS FOR THE SAFE USE OF BEAM CLAMPS

Before using the beam clamp

1. Ensure the identification plate is in place and the weight capacity is clearly legible.
2. Check the pivot points to insure they have free movement
3. Inspect the beam clamp for signs of distortion, cracking, wear, and for any corrosion. Attention should be made to the thread. The thread should be rotated, and should result in the opening and closing of the clamp without restriction. Machine oil or grease should be applied to the thread to maintain the thread

Using beam clamps safely

Ensure that the beam clamp is of the correct capacity for the load being lifted and that the beam or clamp will not be damaged by overloading.

Ensure that the clamp is fitted correctly over the centre of the item being lifted and will not be subjected to side loading.

In-service inspection and maintenance

Ensure that beam clamps are kept clean and moving parts are lubricated

Regularly inspect beam clamps for wear, damage, distortion, cracks and any defects likely to cause the beam clamp to fail or be dangerous

If any of the above defects are found remove the beam clamp from service and refer to a competent person for inspection and testing.

